

TECHNICAL MANUAL

TM 9-1240-298-34P

HEADQUARTERS
DEPARTMENT OF THE ARMY
WASHINGTON, D.C. 20 July 1972

**DIRECT SUPPORT AND GENERAL SUPPORT MAINTENANCE
REPAIR PARTS AND SPECIAL TOOLS LIST (INCLUDING DEPOT
MAINTENANCE REPAIR PARTS AND SPECIAL TOOLS)
FOR
SIGHT UNIT M34 (1240-759-7854), M34A1 (124-764-7931),
M34A2 (1240-300-7989) AND M34A2C (1240-783-5932)**

Current as of 28 June 1972

Table of Contents

	Page	Illus Figure
Section I. Introduction -----	4	
Section II. Repair parts list -----	8	
2226 Sight Unit M34 (7597854) -----	7	1
2227 Sight Unit M34A1 (7647931) -----	7	1
2228 Sight Unit M34A2 (8244840) -----	7	2
2229 Sight Unit M34A2C (7674715) -----	7	2
2226.1 Sight Unit M34 (7597854) -----	8	3
2227.1 Sight Unit M34A1 (7674931) -----	8	3
2228.1 Sight Unit M34A2 (8244840) -----	8	3
2229.1 Sight Unit M34A2C (7674715) -----	8	3
2226.2 Level Fire Control Instrument (6271189) -----	2	4
2227.2 Level Fire Control Instrument (6271189) -----	12	4
2228.2 Level Fire Control Instrument (6271189) -----	12	4
2229.2 Level Fire Control Instrument (6271189) -----	12	4
2226.3 Mount Telescope M79 (7597745) -----	14	5
2227.3 Mount Telescope M79 (7597745) -----	14	5
2228.3 Mount Telescope M79 (7597745) -----	14	5
2229.3 Mount Telescope M79 (7597745) -----	14	5
2226.4 Level Assembly (7637593) W/Related parts -----	16	6
2227.4 Level Assembly (7637593) W/Related Parts -----	16	6
2228.4 Level Assembly (7637593) W/Related Parts -----	16	6
2229.4 Level Assembly (7637593) W/Related Parts -----	16	6
2226.5 Level Assembly (7637593) -----	18	7
2227.5 Level Assembly (7637593) -----	18	7
2228.5 Level Assembly (7637593) -----	18	7
2229.5 Level Assembly (7637593) -----	18	7
2226.6 Worm (7640654) W/Related Parts -----	20	8
2227.6 Worm (7640654) W/Related Parts -----	20	8
2228.6 Worm (7640654) W/Related Parts -----	20	8
2229.6 Worm (7640654) W/Related Parts -----	20	8
2226.7 Housing (7693810) W/Related Parts -----	22	9
2227.7 Housing (7693810) W/Related Parts -----	22	9
2228.7 Housing (7693810) W/Related Parts -----	22	9
2229.7 Housing (7693810) W/Related Parts -----	22	9
2226.8 Bracket (7675746) -----	24	10

*This manual supersedes ORD 8 SNL F-366, 22 January 1955; ORD 9 SNL F366, 20 June 1956, including all changes; and TM 9-1290-204-35P, 17 January 1961, including all changes.

		Page	Illus Figure
	2227.8 Bracket (7675746) -----	24	10
	2228.8 Bracket (7675746) -----	24	10
	2229.8 Bracket (7675746) -----	24	10
Section III.	Special tools list-----	26	
	2226.9 Adapter Assembly (7651326)-----	26	11
	2227.9 Adapter Assembly (7651326)-----	26	11
	2228.9 Adapter Assembly (7651326)-----	26	11
	2229.9 Adapter Assembly (7651326)-----	26	11
	2226.10 Adapter Assembly (7651341)-----	26	12
	2227.10 Adapter Assembly (7651341)-----	26	12
	2228.10 Adapter Assembly (7651341)-----	26	12
	2229.10 Adapter Assembly (7651341)-----	26	12
	2226.11 Adapter Assembly (7651347)-----	26	12
	2227.11 Adapter Assembly (7651347)-----	26	12
	2228.11 Adapter Assembly (7651347)-----	26	12
	2229.11 Adapter Assembly (7651347)-----	26	12
Section IV.	Federal stock number and reference number index -----	28	

LIST OF ILLUSTRATIONS

Figure	Illustration	Page
1	Sight Unit M34 and M34A1- -----	7
2	Sight Unit M34A2 and M34A2C-----	7
3	Sight Unit M34, M34A1, M34A2 and M34A2C- -----	9
4	Level, Fire Control Instrument .--- -----	13
5	Mount Telescope M79-----	15
6	Level Assembly W/Related Parts-----	17
7	Level Assembly -----	19
8	Worm W/Related Parts - -----	21
9	Housing W/Related Parts -----	23
10	Bracket-----	25
11	Adapter Assembly-----	27
12	Adapter Assemblies -----	27

Section I. INTRODUCTION

1. Scope.

This manual lists repair parts, special tools, and support equipment required for the performance of direct support, general support and depot maintenance of the sight unit M34 series.

2. General.

This Repair Parts and Special Tools List is divided into the following sections:

a. Repair Parts List--Section II. A list of repair parts authorized at the direct support, general support, and depot levels for the performance of maintenance. This list also includes parts which must be removed for the replacement of the authorized parts. Parts lists are composed of functional groups in ascending numerical sequence, with parts in each group listed in figure and item number sequence.

b. Special Tools List-Section III. A list of special tools, test and support equipment authorized for the performance of maintenance at the direct support, general support and depot levels.

c. Federal Stock Number and Reference Number Index-Section IV. A list, in ascending numerical sequence, of all Federal stock numbers appearing in the listings followed by a list, in alphanumeric sequence, of all reference numbers appearing in the listings. Federal stock number and reference numbers are cross-referenced to each illustration figure and item number appearance.

3. Explanation of Columns.

The following provides an explanation of columns found in the tabular listings.

a. Source, Maintenance, and Recoverability Codes (SMR).

(1) Source Code. Indicates the manner of acquiring support items for maintenance, repair, or overhaul of end items. Source codes are:

Code	Explanation
PA	Item procured and stocked for anticipated or known usage.
PB	Item procured and stocked for insurance pur-

Code	Explanation
	poses because essentially dictates that a minimum quantity be available in the supply systems.
PC	Item procured and stocked and which otherwise would be coded "PA" except that it is deteriorate in nature.
PD	Support item, excluding support equipment, procured for initial issue or outfitting and stocked only for subsequent or additional initial issues or outfitting. Not subject to automatic replenishment.
PE	Support equipment procured and stocked for initial issue or outfitting to specified maintenance repair activities.
PF	Support equipment which will not be stocked but which will be centrally procured on demand.
MO	Item to be manufactured or fabricated at Organizational level.
MF	Item to be manufactured or fabricated at Direct Support level.
MH	Item to be manufactured or fabricated at General Support.
MD	Item to be manufactured or fabricated at Depot Maintenance level.
AO	Item to be assembled at Organizational level.
AF	Item to be assembled at Direct Support.
AH	Item to be assembled at General Support.
AD	Item to be assembled at Depot Maintenance level.
XA	Item is not procured or stocked because the requirements for the item will result in the replacement of the next higher assembly.
XB	Item is not intended for procurement and is not stocked If not available thru salvage, requisition.
XC	Installation drawing, diagram, instruction sheet, field service drawing, that is identified by manufacturers part number.
	(2) Maintenance Codes. Indicates the levels of maintenance authorized to USE and REPAIR support items.
	(a) Use code. Indicates the lowest maintenance level authorized to remove, replace, and use the support item. Use codes are:
Code	Explanation
C	Used to denote crew or operator maintenance performed within Organizational maintenance.
O	Support item is removed, replaced, used at the Organizational level of maintenance.

Code	Explanation
F	Support item is removed, replaced, used at Direct Support.
H	Support item is removed, replaced, used at General Support.
D	Support item is removed, replaced used at Depot only.

(b) Repair code. Indicates whether the item is to be repaired and identifies the lowest maintenance level with the capability to perform complete repair (i.e., all authorized maintenance functions). Repair codes are:

Code	Explanation
O	The lowest maintenance level capable of complete repair of the support item is the Organizational level.
F	The lowest maintenance level capable of complete repair of the support item is Direct Support.
H	The lowest maintenance level capable of complete repair of the support item is General Support.
D	The lowest maintenance level capable of complete repair of the support item is the Depot level.
Z	Non-repairable.

(3) Recoverability Codes. Indicates the disposition action on unserviceable items. Recoverability codes are:

Code	Explanation
EZ	Non-repairable item. When unserviceable, condemn and dispose at the level authorized to replace the item.
F	Repairable item. When uneconomically repairable, condemn and dispose at Direct Support level.
H	Repairable item. When uneconomically repairable, condemn and dispose at General Support level.
D	Repairable item. When beyond lower level repair capability, return to Depot. Condemnation and disposal not authorized below Depot level.
L	Repairable item. Repair, condemnation and disposal not authorized below depot/specialized repair activity level.
A	Item requires special handling or condemnation procedure because of specific reasons (i.e., precious metal content, high dollar value, critical material or hazardous material). Refer to appropriate manuals/directives for specific instructions. <ul style="list-style-type: none"> b. Federal Stock Number. Indicates the Federal stock number assigned to the item and will be used for requisitioning purposes. c. Description. Indicates the Federal item name and a minimum description required to identify the item. The last line indicates the reference number followed by the applicable Federal Supply

Code for Manufacturer (FSCM) in parentheses. The FSCM is used as an element in item identification to designate manufacturer or distributor or Government Agency, etc., and is identified in SB 708-42.

d. Unit of Measure (U/M). Indicates the standard or basic quantity by which the listed item is used in performing the actual maintenance function. This measure is expressed by a two-character alphabetical abbreviation, e.g., ea, in, pr, etc., and is the basis used to indicate quantities and allowances in subsequent columns. When the unit of measure differs from the unit of issue, the lowest unit of issue that will satisfy the required units of measure will be requisitioned.

e. Quantity Incorporated in Unit. Indicates the quantity of the item used in the breakout shown in the illustration figure, which is prepared for a functional group, subfunctional group, or an assembly. A "V" appearing in this column in lieu of a quantity indicates that no specific quantity is applicable, e.g., shims, spacers, etc.

f. O30-Day DS/GS Maintenance Allowances.

(1) The repair parts indicated by asterisk (*) entries in separate allowance column(s) for DS and GS represents those parts authorized for use at that category of maintenance and will be requisitioned on an "as required" basis.

(2) Allowance quantities are indicated in the special tools list section for special tools, TMDE, and other support equipment.

g. 1-Year Allowances Per 100 Equipments/Contingency Planning Purposes. No entries will appear in this column.

h. Depot Maintenance Allowances Per 100 Equipments. This column indicates that the items identified with an asterisk (*) are authorized to be requisitioned "as required".

i. Illustration. This column is divided as follows:

(1) Figure, Number. Indicates the figure number of the illustration on which the item is shown.

(2) Item Number. Indicates the callout number used to reference the item on the illustration.

4. Special Information.

a. Usable on codes are included in Column 3. Uncoded items are applicable to all models. Identification of the usable on codes used in this publication are:

Code	Used On
A	M34
B	M34A1
C	M34A2
D	M34A2C
E	M34, M34A1
F	M34A1, M34A2
G	M34A2, M34A2C

b. Action change codes indicated in the left-hand margin of the listing page denote the following:
N-Indicates an added item.
C-Indicates a change in data.
R-Indicates a change in FSN only.

c. To maintain disassembly sequence in this manual, a number in parentheses will be displayed immediately to the right of the callout number on the illustration.

d. Refer to TM 9-1240-213-35P repair parts for Telescope Elbow M62, M62A1C and M63A1D, and TM 9-1240-242-34P for Adapter Telescope M9 and M9A1.

e. The following publications pertain to sight unit M34 series.

TM 9-1015-200-12	Operator and Organizational Maintenance Manual for mortar, 81-mm M29A1 (1015-999-7794) and mortar 81-mm M29 (1015-840-1836).
TM 9-1015-200-20P	Organizational Maintenance Repair Parts and Special Tools List for mortar 81-mm M29 (1015-840-1836), mortar 81-mm M29A1 (1015-999-7794).
TM 9-1015-215-12	Operator and Organizational Maintenance Manual: Mortar 4.2 inch (cannon M30 on mount M24 or M24A1) and Mortar Subcaliber, 60 mm M31.
TM 9-1015-215-20P	Organizational Maintenance Repair Parts and Special Tools List, Mortar 4.2 inch cannon M30 on mount M24 (1015322-9720) or M24A1 (1015-840-1840), and Mortar, Subcaliber 60 millimeter M31.
TM 9-3140	Operator and Organizational Maintenance 75-mm rifles M30 and T21E12, tripod mount M917A2, and weapon tripod mount M74.
SM ORD 7-C-74	Rifle 75-mm, M20 and T21E12 (to 39A-5BE-5)
SM ORD C-74	Rifle 75-mm M20 T21E12
SM ORD 9-C-74	Rifle 75-mm M20 T21E12
TM 9-1055215-12	Sight Unit M34A2C.
TM 9-1055215-12	Operator and Organizational Maintenance Manual 115 mm Multiple Rocket Launcher M91.
TM 91055-215-20P	Organizational Maintenance Repair Parts and Special Tools List for 155-mm Multiple Rocket Launcher M91 (T145).

5. How to Locate Repair Parts.

a. When Federal stock number or reference number is unknown:

(1) First. Using the table of contents determine the functional or subfunctional group within which the repair part belongs, i.e., engine, engine assembly, transmission, transmission assembly. This is necessary since illustrations are prepared for functional and subfunctional groups, and listings are divided into the same groups.

(2) Second. Find the illustration covering the functional or subfunctional group to which the repair part belongs.

(3) Third. Identify the repair part on the illustration and note the illustration figure and item number of the repair part.

(4) Fourth. Using the Repair Parts Listing, find the functional or subfunctional group to which the repair part belongs and locate the illustration figure and item number noted on the illustration.

b. When Federal stock number or reference number is known:

(1) First. Using the index of Federal Stock Numbers and Reference Numbers find the pertinent Federal stock number or reference number. This index is in ascending FSN sequence followed by a list of reference numbers in ascending alphanumeric sequence, cross-referenced to the illustration figure number and item number.

(2) Second. Using the Repair Parts Listing, find the functional or subfunctional group of the repair part and the illustration figure number and item number referenced in the Index of Federal Stock Numbers and Reference Numbers.

6. Abbreviations.

Abbreviations	Explanation
brz	bronze
cp	cone point
cres	corrosion resistant steel
cskh	counter sunk
d	deep
dia	diameter
filh	fillister head
fl	flat
fnsh	finish
fp	flat point
hdls	headless
hex soc	hexagon socket
hld	helical
id	inside diameter
intl	initial
l	long
nf	national fine
no	number
oa	overall

Abbreviation

od
pnh
psvt
pt
rec
rh
sld
smls
spcl
spr
stl
tbg
thd
thk
u/o
unf
w

Explanation

outside diameter
pan head
passivate
point
recess
right hand
slotted
seamless
special
spring
steel
tubing
thread
thick
used on
unified fine thread
wide

7. Recommendations for Maintenance Publications Improvements.

You can improve this manual by calling attention to errors and by recommending improvements, using DA Form 2028 (Recommended Changes to Publications) or by a letter, and mailing directly to Commanding Officer, Frankford Arsenal, ATTN: AMSWEMAFW3100, Philadelphia, Pennsylvania 19137. A reply will be furnished directly to you.

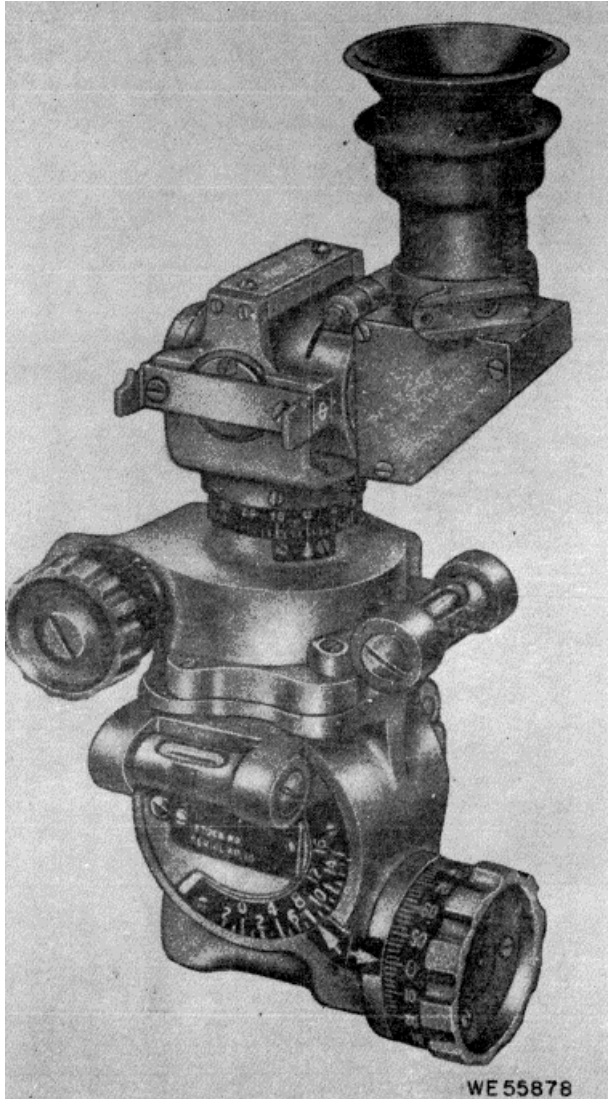

Figure 1. Sight Unit MA34 and M34A1.

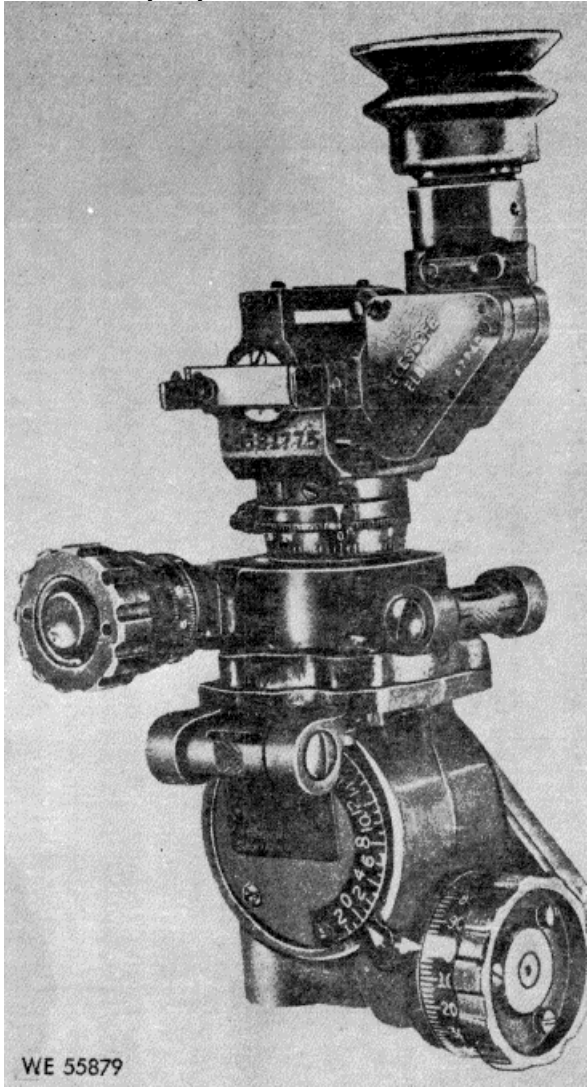
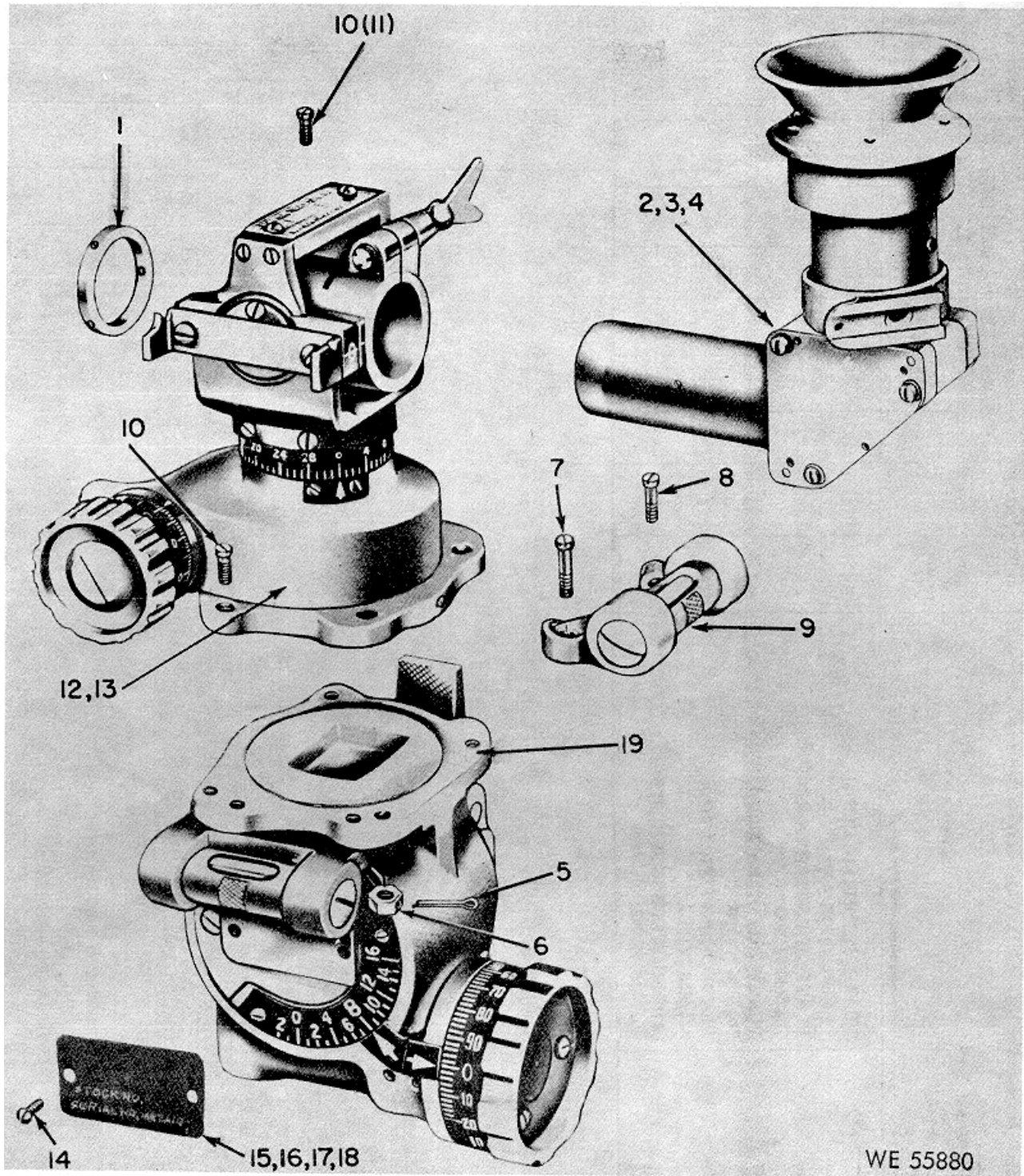

Figure 2. Sight Unit MS4A2 and M34A2C.



WE 55880

Figure 3. Sight Unit MS4, MS4A1, MS4A2 and MS4A2C.

Act on Code	(1) Source Maint and Recov Code			(2) Federal Stock No.	(3) Description		(4) Unit of Meas	(5) Qty Inc in Unit	(6) 30-Day DS Maint Allowance			(7) 30-Day GS Maint Allowance			(8) 1-Yr Alw Per 100 Equip Cntgcy	(9) Depot Maint Alw Per 100 Equip	(10) Illustration	
	(a)	(b)	(c)		<i>Reference Number & Mfr Code</i>	<i>Usable on Code</i>			(a)	(b)	(c)	(a)	(b)	(c)			(a)	(b)
	Source	Maint	Recov						1-20	21-50	51-100	1-20	21-50	51-100			Fig. No.	Item No.
N	XB-DZ-Z				PLATE, IDENTIFICATION 7674716 (19200)	D	EA	1									3	17
C	XB-DZ-Z				PLATE, IDENTIFICATION 7647846 (19200)	B	EA	1									3	16
C	XB-DZ-Z				PLATE, IDENTIFICATION 7647850 (19200)	A	EA	1									3	17
N	XB-DZZ				PLATE, IDENTIFICATION 8244838 (19200)	C	EA	1									3	18
C	XA				MOUNT, TELESCOPE M79 7597745 (19200)			1									3	19

Act on Code	(1) Source Maint and Recov Code			(2) Federal Stock No.	(3) Description <i>Reference Number & Mfr Code</i> <i>Usable on Code</i>	(4) Unit of Meas	(5) Qty Inc in Unit	(6) 30-Day DS Maint Allowance			(7) 30-Day GS Maint Allowance			(8) 1-Yr Alw Per 100 Equip Cntgcy	(9) Depot Maint Alw Per 100 Equip	(10) Illustration	
	(a)	(b)	(c)					(a)	(b)	(c)	(a)	(b)					
	Source	Maint	Recov					1-20	21-50	51-100	1-20	21-50	51-100			(a) Fig. No.	(b) Item No.
C	PA-FZ-Z			5315-591-3393	PIN, STRAIGHT, HEADLESS 0.062 DIS, 0.625 L 502908 (21450)	EA	2	*	*	*	*	*	*	*	4	1	
C	PA-FZ-Z			5365-200-0816	PLUG, MACHINE, THREAD 5034055 (19200)	EA	2	*	*	*	*	*	*	*	4	2	
C	PA-FZ-Z			1240-764-5307	TUBE, LEVEL, VIAL 7645307 (19200)	EA	1	*	*	*	*	*	*	*	4	4	
N	PA-FZ-Z			5305-068-6708	SETSCREW HEX SOC, CP, CRES, PSVT FNSH NO 2-64 UNF-3A, 1/8 L MS51038-16 (96906)	EA	4	*	*	*	*	*	*	*	4	5	
C	PA-FZ-Z			1290-503-4039	COVER, LEVEL, TYPE E1 SMLS BR Z TBG, 0.996 OD 5034039 (19200)	EA	1	*	*	*	*	*	*	*	4	6	
C	PA-DZ-Z			1290-627-1190	BRACKET, LEVEL CROSS, PINNED, STL 1.700 L, 0.55 DIA 6271190 (19200)	EA	1							*	4	7	

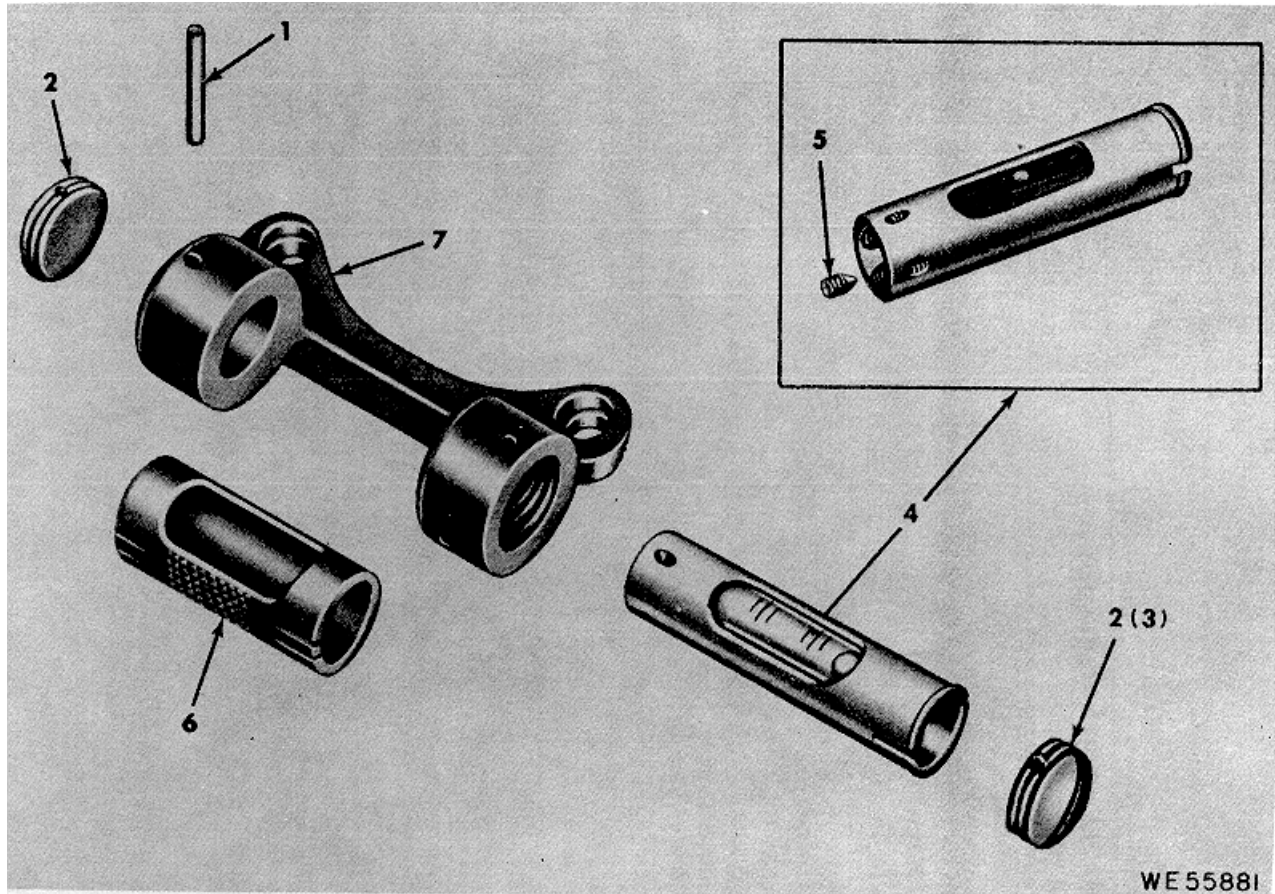

WE 55881

Figure 4. Level, fire control instrument.

Act on Code	(1) Source Maint and Recov Code			(2) Federal Stock No.	(3) Description <i>Reference Number & Mfr Code</i> <i>Usable on Code</i>	(4) Unit of Meas	(5) Qty Inc in Unit	(6) 30-Day DS Maint Allowance			(7) 30-Day GS Maint Allowance			(8) 1-Yr Alw Per 100 Equip Cntgcy	(9) Depot Maint Alw Per 100 Equip	(10) Illustration	
	(a)	(b)	(c)					(a)	(b)	(c)	(a)	(b)					
	Source	Maint	Recov					1-20	21-50	51-100	1-20	21-50	51-100			(a) Fig. No.	(b) Item No.
N	PA-FZ-Z			5305-057-0498	MOUNT TELESCOPE: M79 (75977) SCREW, MACHINE PNH, CROSS REC, CRES, PSVT FNSH NO 2-64 UNF-2A, 3/16 L MS51958-2 (96906)	EA	6	*	*	*	*	*	*	*	5	1	
N	XB-DZ-Z				PLATE 8244515 (19200)	EA	1	5	2								
N	PA-FZ-Z			5310-543-4652	WASHER, FL, INTL T, CRES, PSVT FNSH 0.095 ID, 0.200 OD, 0.015 THK MS35333-69 (96906)	LOCK	EA	2	*	*	*	*	*	*	5	4	
N	PA-DZ-Z			5355-757-9314	DIAL, SCALE 7579314 (00000)	EA	1	*							5	5	
N	XA-				MOUNT ASSEMBLY 7691471 (1920)		1								5	6	

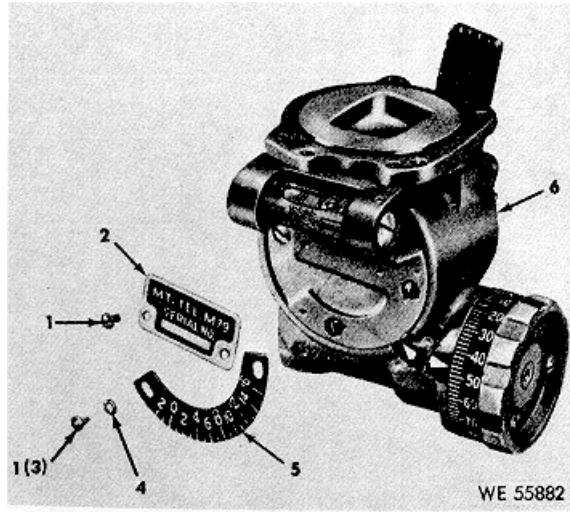

Figure 5. Mount telescope M79.

Act on Code	(1) Source Maint and Recov Code			(2) Federal Stock No.	(3) Description <i>Reference Number & Mfr Code</i> <i>Usable on Code</i>	(4) Unit of Meas	(5) Qty Inc in Unit	(6) 30-Day DS Maint Allowance			(7) 30-Day GS Maint Allowance			(8) 1-Yr Alw Per 100 Equip Cntgcy	(9) Depot Maint Alw Per 100 Equip	(10) Illustration	
	(a) Source	(b) Maint	(c) Recov					(a) 1-20	(b) 21-50	(c) 51-100	(a) 1-20	(b) 21-50	(c) 51-100			(a) Fig. No.	(b) Item No.
	PA-FZ-Z							5305-701-5059	LEVEL ASSEMBLY (7637593) W/RELATED PARTS SCREW, MACHINE PNH, CROSS REC, PSVT FNSH NO 8-36 UNF-2A, 3/8 L MS51958-43 (96906)	EA	2	*	*			*	*
PA-FZ-Z			5310-933-8119	WASHER, LOCK SPR HLCL, CRES, PSVT FNSH, 0.175 ID, 0.293 OD, 0.040 THK MS35338-137 (96906)	EA	2	*	*	*	*	*	*	*	*	6	2	
XA-				LEVEL ASSEMBLY 7637593 (19200)		1									6	3	

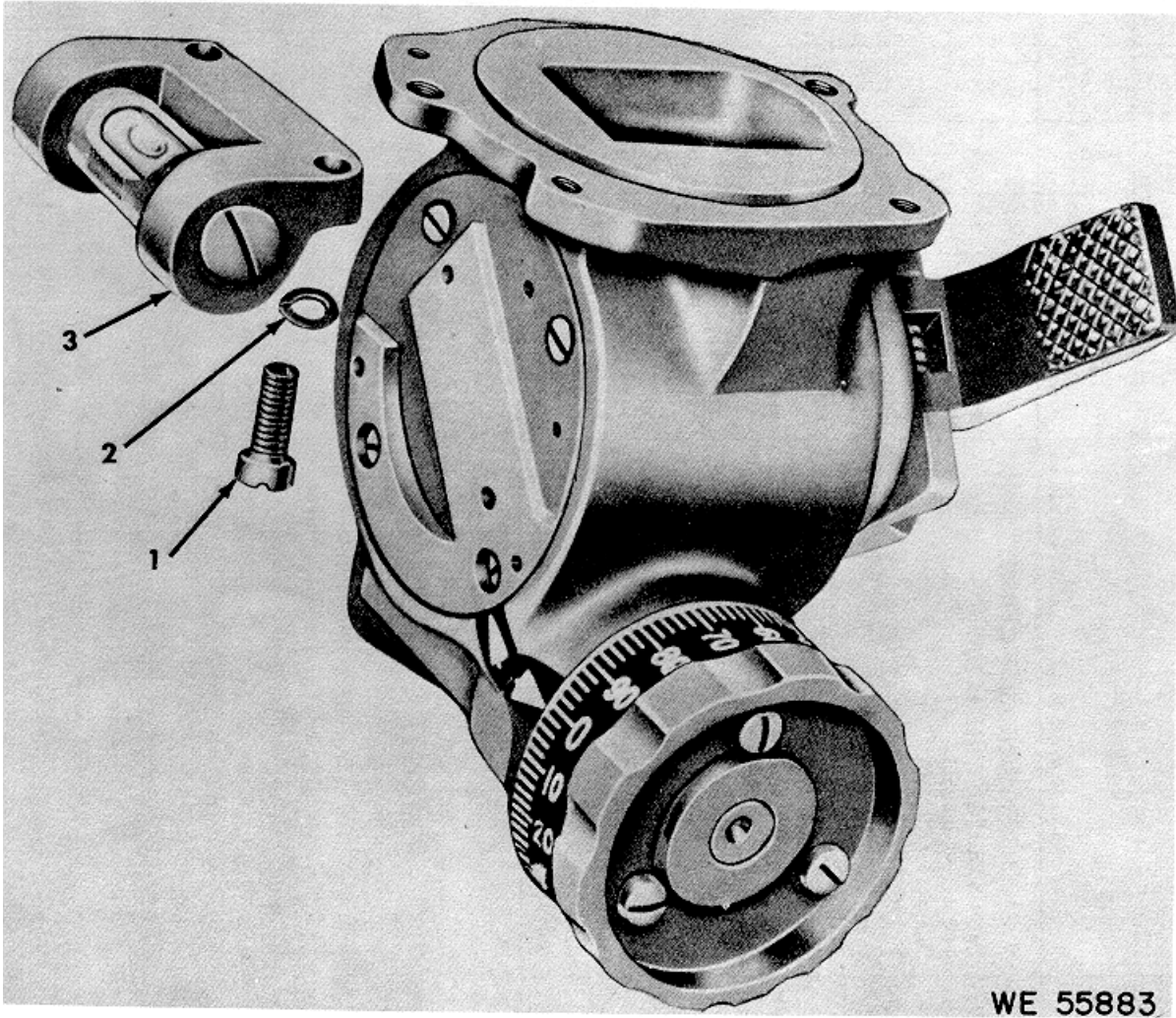
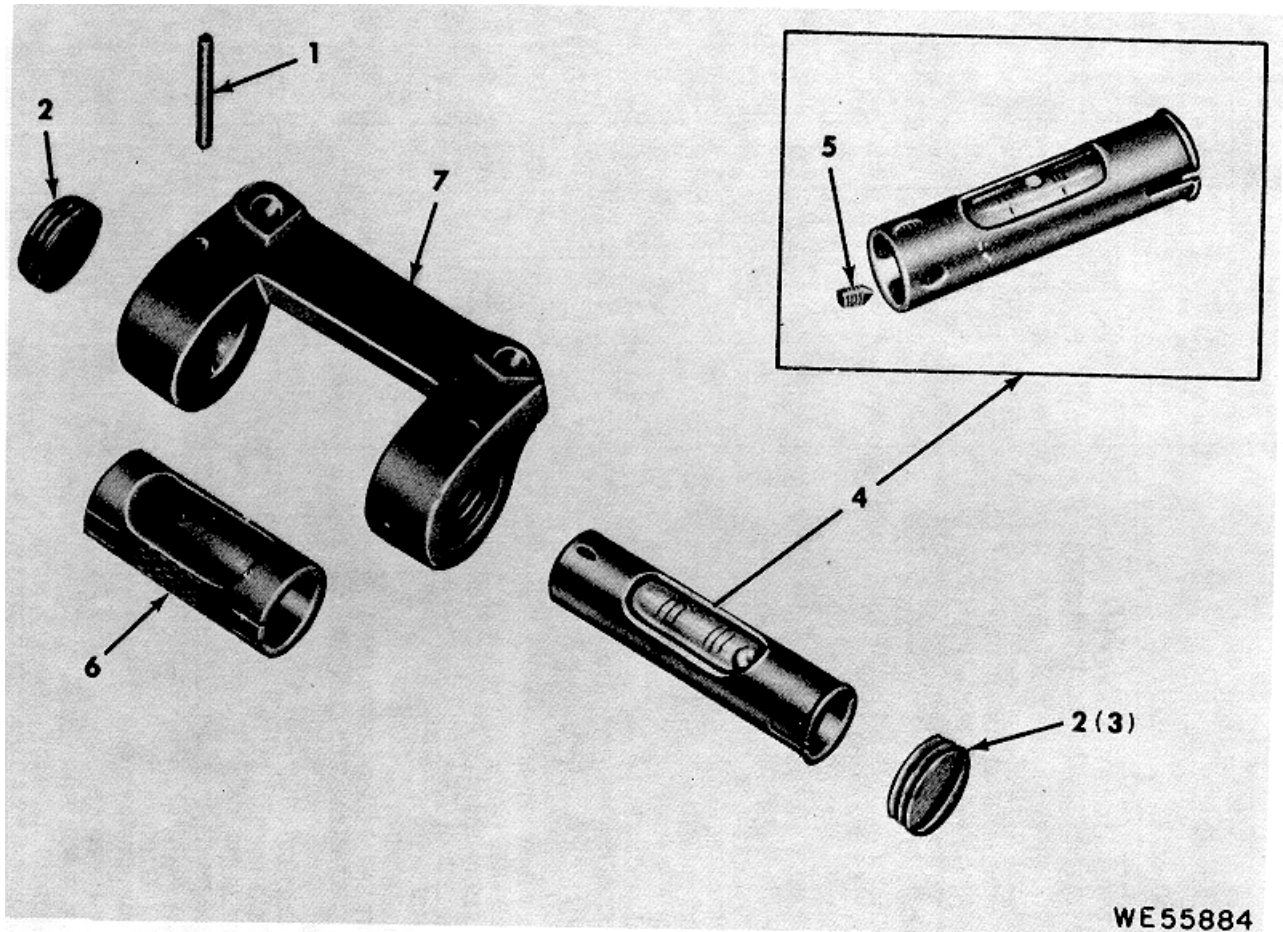

Figure 6. Level assembly w/related parts.

Act on Code	(1) Source Maint and Recov Code			(2) Federal Stock No.	(3) Description <i>Reference Number & Mfr Code</i> <i>Usable on Code</i>	(4) Unit of Meas	(5) Qty Inc in Unit	(6) 30-Day DS Maint Allowance			(7) 30-Day GS Maint Allowance			(8) 1-Yr Alw Per 100 Equip Cntgcy	(9) Depot Maint Alw Per 100 Equip	(10) Illustration	
	(a)	(b)	(c)					(a)	(b)	(c)	(a)	(b)					
	Source	Maint	Recov					1-20	21-50	51-100	1-20	21-50	51-100			(a) Fig. No.	(b) Item No.
C	PA-FZ-Z			5316-591-3393	LEVEL ASSEMBLY (7637593) PIN, STRAIGHT, HEADLESS 0.062 DIA, 0.625 L 502908 (21450)	EA	2	*	*	*	*	*	*	*		7	1
C	PA-FZ-Z			5365-200-0816	PLUG, MACHINE, THREAD 5034055 (19200)	EA	2	*	*	*	*	*	*	*		7	2
C	PA-FZ-Z			1240-764-5307	TUBE, LEVEL VIAL (CEMENTED) 7645307 (19200)	EA	1	*	*	*	*	*	*	*		7	4
N	PA-FZ-Z			5305-068-6708	SETSCREW HEX SDC, CP, CRES, PSVT FNSH, NO 2-64 UNF-3A, 1/8 MS51038-16 (96906)	EA	4	*	*	**	*	*	*	*		7	5
C	PA-FZ-Z			1290-503-4039	COVER, LEVEL, TYPE SMLS BRZ TBG, 0.990 OD 5034039 (19200)	E1	EA	1	*	*	*	*	*	*		7	6
N	XB-DZ-Z				BRACKET 7637594 (19200)	EA	1									7	7



WE55884

Figure 7. Level assembly.

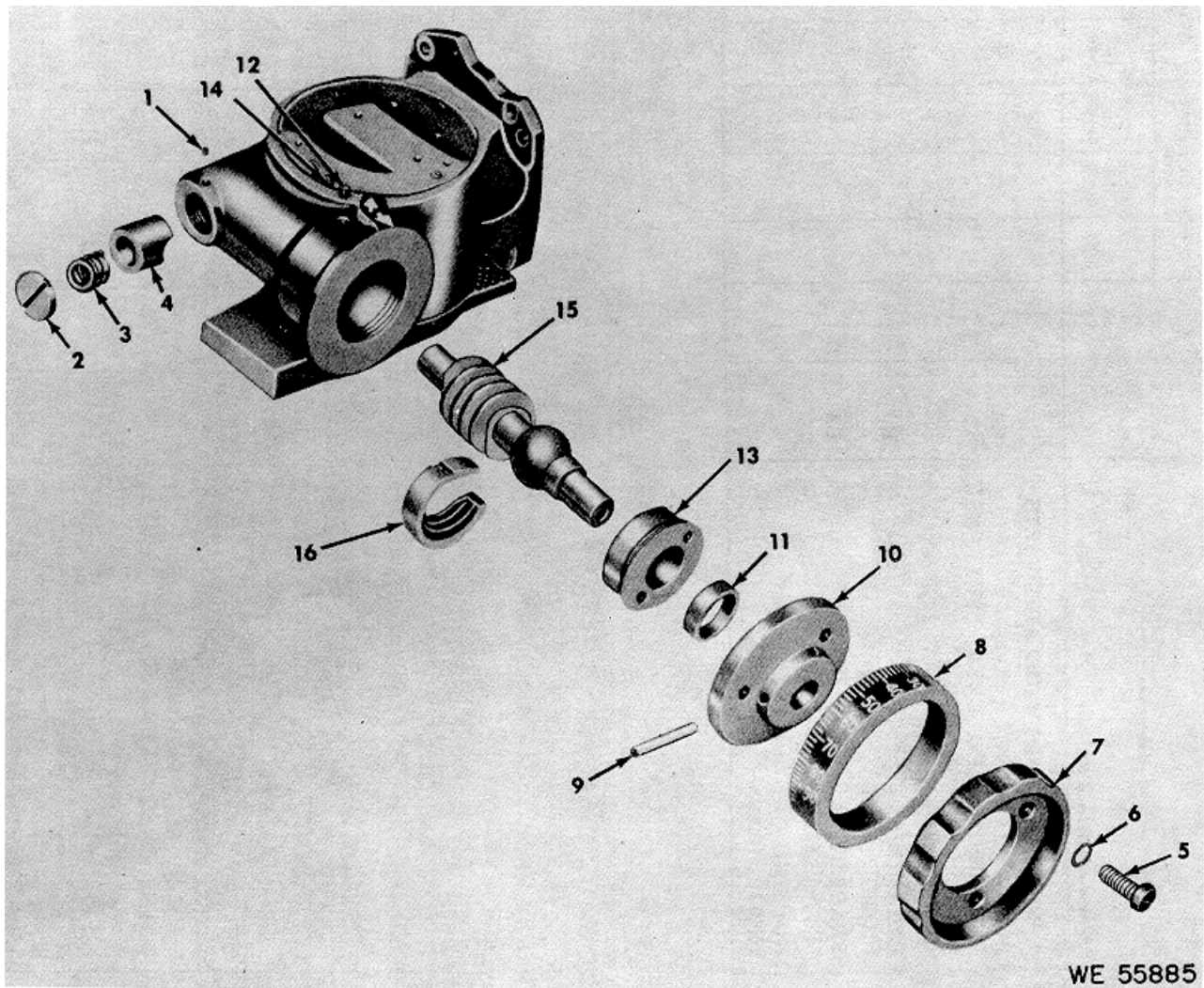

Figure 8. Worm w/related parts.
21

Act on Code	(1) Source Maint and Recov Code			(2) Federal Stock No.	(3) Description Reference Number & Mfr Code Usable on Code	(4) Unit of Meas	(5) Qty Inc in Unit	(6) 30-Day DS Maint Allowance			(7) 30-Day GS Maint Allowance			(8) 1-Yr Alw Per 100 Equip Cntgcy	(9) Depot Maint Alw Per 100 Equip	(10) Illustration	
	(a) Source	(b) Maint	(c) Recov					(a) 1-20	(b) 21-50	(c) 51-100	(a) 1-20	(b) 21-50	(c) 51-100			(a) Fig. No.	(b) Item No.
	N	PA-HZ-Z							530s-057-0522	HOUSING (76931) RELATED PARTS SCREW, MACHINE PNH, CROSS REC, CRES, FNSH, NO 6-40 UNF-2A, 1/4 L MS51958-26 (96906)	EA	4					
N	XB-DZ-Z				RETAINER 7644609 (19200)	EA	1								9	2	
N	XB-DZ-Z				BRACKET 7675746 (19200)	EA	1								9	3	
N	XA-				HOUSING 7693810 (19200)		1								9	4	

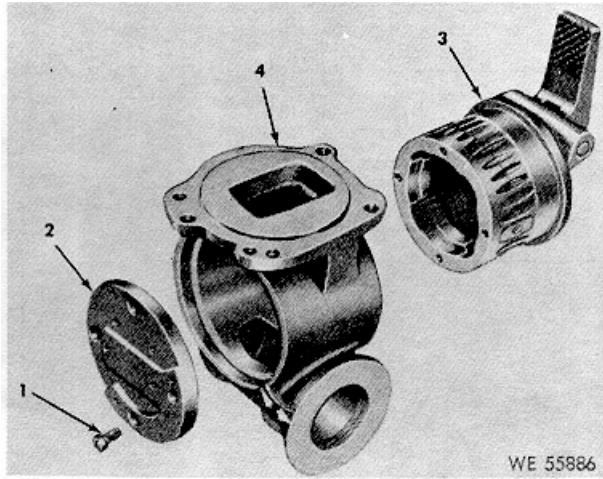

Figure 9. Housin7 w/related parts.

Act on Code	(1) Source Maint and Recov Code			(2) Federal Stock No.	(3) Description <i>Reference Number & Mfr Code</i> <i>Usable on Code</i>	(4) Unit of Meas	(5) Qty Inc in Unit	(6) 30-Day DS Maint Allowance			(7) 30-Day GS Maint Allowance			(8) 1-Yr Alw Per 100 Equip Cntgcy	(9) Depot Maint Alw Per 100 Equip	(10) Illustration	
	(a) Source	(b) Maint	(c) Recov					(a) 1-20	(b) 21-50	(c) 51-100	(a) 1-20	(b) 21-50	(c) 51-100			(a) Fig. No.	(b) Item No.
	N	PA-HZ-Z							5305-829-0105	BRACKET (7675746) SCREW, MACHINE FL CSKH, CROSS REC, CRES, PSVT FNSH NO 2-64 UNF-2A, 1/8 L MS51960-6 (96906)	EA	2					
N	PA-DZ-Z			1240-570-6585	STOP BRZ 0.240 W, 0.120 THK, 0.750 L 7579319 (19200)	EA	2							*	10	2	
N	XB-DZ-Z				PIN, STRAIGHT 5043135 (19200)	EA	1								10	3	
N	PA-HZ-Z			6360-597-7508	SPRING 5043139 (00000)	EA	1				*	*	*	*	10	4	
N	PA-DZ-Z			1240-555-6411	LATCH, LOCKING U/O SIGHT M4 5556411 (19200)	EA	1							*	10	5	
N	XB-SZ-Z				BRACKET 7693811 (19200)	EA	1								10	6	

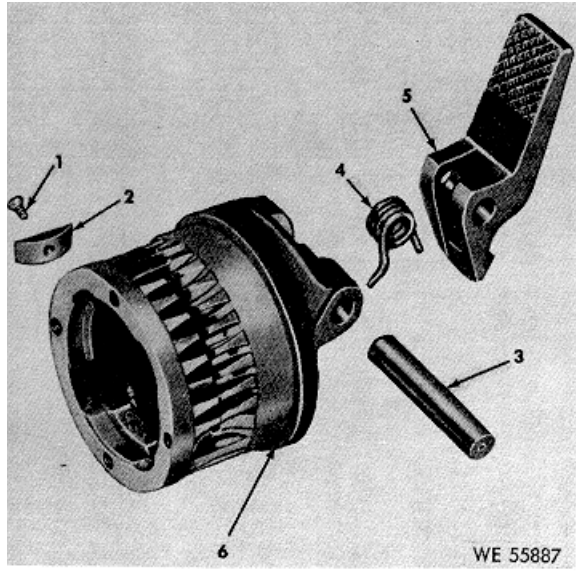

Figure 10. Bracket.

Section III. SPECIAL TOOL LIST

Act on Code	(1) Source Maint and Recov Code			(2) Federal Stock No.	(3) Description <i>Reference Number & Mfr Code</i> <i>Usable on Code</i>	(4) Unit of Meas	(5) Qty Inc in Unit	(6) 30-Day DS Maint Allowance			(7) 30-Day GS Maint Allowance			(8) 1-Yr Alw Per 100 Equip Cntgcy	(9) Depot Maint Alw Per 100 Equip	(10) Illustration	
	(a) Source	(b) Maint	(c) Recov					(a) 1-20	(b) 21-50	(c) 51-100	(a) 1-20	(b) 21-50	(c) 51-100			(a) Fig. No.	(b) Item No.
	N	PA-HZ-Z							4931-765-1328	TOOLS AND EQUIPMENT TOOLS ADAPTER STL, 1.414 ID, 3 L 7551328 (19200)	EA	1					
N	PA-HZ-Z			4931-765-1326	ADAPTER ASSEMBLY AZIMUTH TEST FIXTURE 7651326 (19200)	EA	1				*	*	*	*	11	2	
N	PA-HZ-Z			4931-765-1341	ADAPTER, ASSEMBLY AZIMUTH TEST FIXTURE 7651341 (19200)	EA	1				*	*	*	*	12	1	
N	PA-HZ-Z			4931-765-1347	ADAPTER ASSEMBLY AZIMUTH TEST FIXTURE 7651347 (19200)	EA	1				*	*	*	*	12	2	

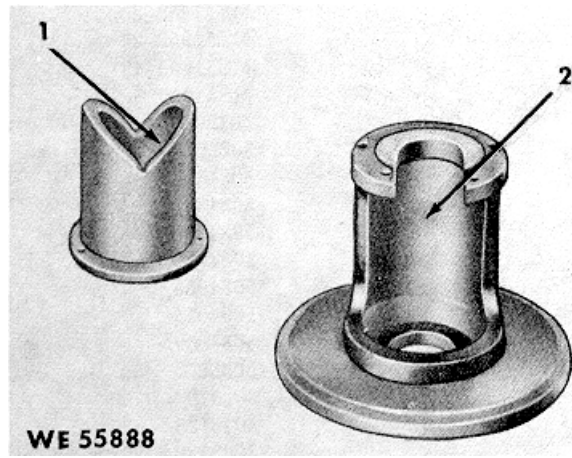

Figure 11. Adapter assembly.

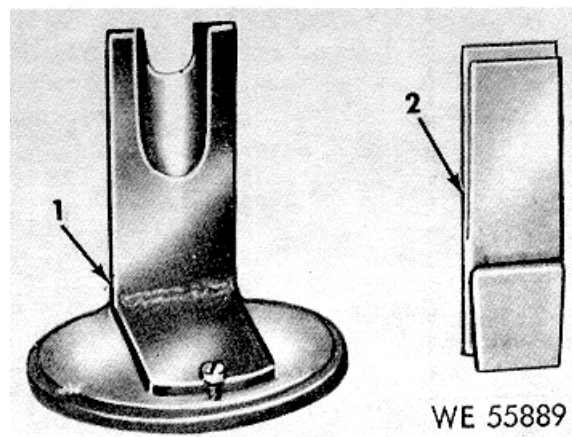

Figure 12. Adapter assemblies.

**Section IV. FEDERAL STOCK NUMBER AND REFERENCE
NUMBER INDEX**

STOCK NUMBER	FIGURE NO	ITEM NO	REFERENCE NO.	MFR CODE	FIGURE NO.	ITEM NO.
1240-300-7988	3	13				
1240-344-4650	3	12	MS51038-16	96906	4	5
1240-505-5290	8	13	MS51038-16	96906	7	5
1240-513-2074	8	16	MS51958-2	96906	3	14
1240-555-6411	10	5	MS51958-2	96906	5	1
1240-570-6585	10	2	MS51958-26	96905	9	1
1240-659-4021	3	3	MS51958-28	96906	8	6
1240-757-9975	3	2	MS51958-43	96906	6	1
1240-758-4615	8	10	MS51960-6	96906	10	1
1240-764-5307	4	4	502908	21450	4	1
1240-764-5307	7	4	502908	21450	7	1
1240-824-3467	3	4	5031378	19200	8	2
1290-503-4039	4	6	5031380	00000	3	6
1290-503-4039	7	6	5034039	19200	4	6
1290-627-1189	3	9	5034039	19200	7	6
1290-627-1190	4	7	5034055	19200	4	2
1290-757-9313	8	4	5034055	19200	7	2
1290-764-0654	8	15	5034659	00000	8	14
5305-057-0498	3	14	503880	21450	8	1
5305-057-0498	5	1	503919	21450	8	12
5305-057-052	9	1	5043135	OC000	10	3
5305-057-0524	8	5	5043139	19200	10	4
5305-068-6708	4	5	5556411	19200	10	5
5305-038-6708	7	5	6271189	19200	3	9
5305-282-3787	3	7	6271190	19200	4	7
5305-282-3796	3	8	6574529	19200	3	12
5305-282-7644	8	1	7579313	19200	8	4
5305-282-7650	8	12	7579314	00000	5	5
5305-503-4659	8	14	7579315	19200	3	8
5305-701-5059	6	1	7579318	19200	8	3
5305-829-0105	10	1	7579319	19200	10	2
5305-912-7642	3	10	7579320	19207	8	11
5310-285-7423	8	11	7579975	19200	3	2
5310-543-4652	5	4	7584615	19200	8	10
5310-639-7438	3	6	7584618	19200	8	7
5310-929-6395	8	6	7584619	19200	8	8
5310-933-8119	6	2	7585588	19200	3	7
5315-187-3245	8	9	7597745	19200	3	19
5315-591-3393	4	1	7637593	19200	6	3
5315-591-3393	7	1	7637594	19200	7	7
5315-815-1405	3	5	7640654	19200	8	15
5340-597-2028	8	3	7644609	19200	9	2
5355-667-9477	8	7	7645307	19200	4	4
5355-757-9314	5	5	7645307	19200	7	4
5355-758-4619	8	8	7647846	19200	3	16
5360-597-7508	10	4	7647850	19200	3	17
5365-200-08t6	4	2	7651326	19200	11	2
5365-200-0816	7	2	7651328	19200	11	1
5365-278-5329	8	2	7651347	19200	12	2
4931-765-1328	11	1	7674716	19200	3	15
4931-765-1326	11	2	7675746	19200	9	3
4931-765-1341	12	1	7687248	19200	8	16
4931-765-1347	12	2	7687249	19200	8	13
			7694065	19200	8	15
			7691471	19200	5	6
			7693810	19200	9	4
			7693811	19200	10	6
			8243467	19200	3	4
			8244515	19200	5	2
			8244830	19200	3	13
			8244838	19200	3	18
			8572120	19200	3	3

By Order of the Secretary of the Army:

W. C. WESTMORELAND,
General, United States Army,
Chief of Staff.

Official:

VERNE L. BOWERS,
Major General, United States Army,
The Adjutant General.

DISTRIBUTION:

To be distributed in accordance with DA Form 1241, (qty rqr block no. 126) Direct and General Support maintenance requirements for Sight Unit.

RECOMMENDED CHANGES TO EQUIPMENT TECHNICAL PUBLICATIONS



THEN... JOT DOWN THE DOPE ABOUT IT ON THIS FORM, CAREFULLY TEAR IT OUT, FOLD IT AND DROP IT IN THE MAIL!

SOMETHING WRONG WITH THIS PUBLICATION?

FROM: (PRINT YOUR UNIT'S COMPLETE ADDRESS)

DATE SENT

PUBLICATION NUMBER

TM 11-5825-270-10

PUBLICATION DATE

23 Jul 81

PUBLICATION TITLE

Radio Frequency R-2176/FRN

BE EXACT... PIN-POINT WHERE IT IS

PAGE NO.

PARA-GRAPH

FIGURE NO.

TABLE NO.

IN THIS SPACE TELL WHAT IS WRONG AND WHAT SHOULD BE DONE ABOUT IT:

TEAR ALONG PERFORATED LINE

PRINTED NAME, GRADE OR TITLE, AND TELEPHONE NUMBER

SIGN HERE:

DA FORM 2028-2 JUL 79

PREVIOUS EDITIONS ARE OBSOLETE.

P.S.—IF YOUR OUTFIT WANTS TO KNOW ABOUT YOUR RECOMMENDATION MAKE A CARBON COPY OF THIS AND GIVE IT TO YOUR HEADQUARTERS.

